

IPC-602

2U 6-slot Rackmount Chassis with Front USB and PS/2 Interfaces



Features

- 2U-high 6-slot rackmount chassis
- Supports one 5.25" and two 3.5" disk drives (one front-accessible and one internal)
- Butterfly backplane design
- Front-accessible USB and PS/2 connectors
- 250 W/300 W AC ATX and DC power supply options
- Two 40-CFM cooling fans with air filter
- Recommended CPU cards for optimum integration
- Lockable front door prevents unauthorized access



Specifications

Drive Bay		Front-accessible	Internal
	3.5"	1	1
Cooling	Fan	2 (40 CFM each)	
	Air Filter	Yes	
I/O Interface	USB	2 (front-accessible)	
	PS/2	PS/2 Keyboard & mouse, or PS/2 keyboard only, depending on the enclosed CPU board	
Miscellaneous	Notification LEDs	LED displays for power status and HDD activity	
	Rear Panel	Reserved one 9-pin D-SUB opening	
Environment	Temperature	Operating 0 ~ 40 °C (32 ~ 104 °F)	Non-Operating -20 ~ 60 °C (-4 ~ 140 °F)
	Humidity	10 ~ 85 % @ 40 °C, non-condensing	
	Vibration (5-500 Hz)	0.5 Grms	2 G
	Shock	10 G (with 11 ms duration, half sine wave)	30 G
	Acoustic Noise	Less than 52 dB sound pressure at 5 ~ 28 °C (41 ~ 82 °F)	
	Altitude	0 to 3,048 m (0 ~ 10,000 ft)	
Physical Characteristics	Dimensions (W x H x D)	482 x 88 x 450 mm (19" x 3.5" x 17.7")	
	Net Weight	10.7 kg (23.6 lb)	
	Gross Weight	13.0 kg (28.6 lb)	

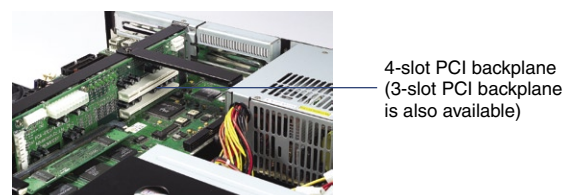
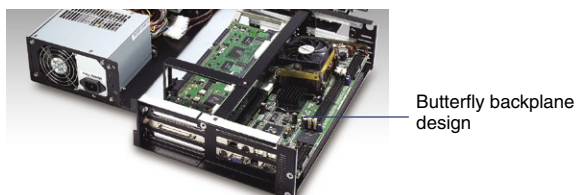
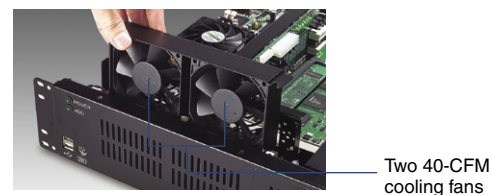

Dimension Diagram

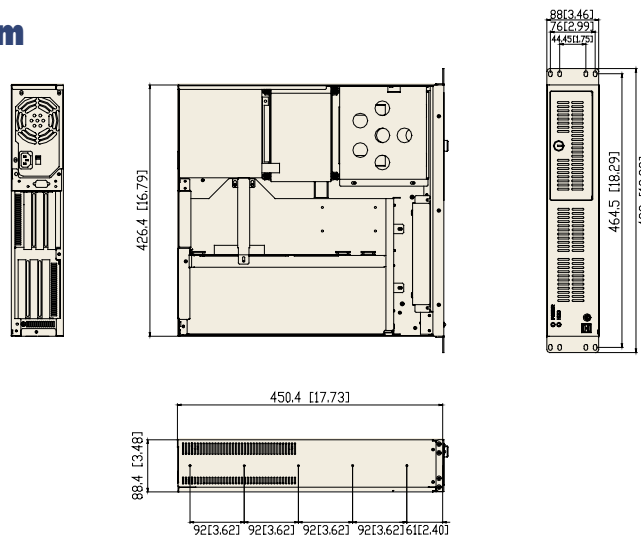

Unit: mm (inch)

Power Supply Options

Part Number	Watt	Input	Specifications			
			Output	Mini-load	Safety	MTBF
PS-250ATX-Z (ATX, PFC)	250 W	AC 115 / 230 V (Selectable)	+5 V @ 27 A, +3.3 V @ 20 A +12 V @ 13 A, -12 V @ 0.8 A -5 V @ 0.3 A, +5 Vsb @ 2 A	+5 V @ 1.5 A +12 V @ 0.3 A	UL/TUV/CB/CCC	100,000 hours @ 25 °C
PS-300ATX-ZB (ATX, PFC)	300W	AC 100 ~ 240 V (Full range)	+5 V @ 30 A, +3.3 V @ 28 A +12 V @ 15 A, -12 V @ 0.8 A -5 V @ 0.3 A, +5 Vsb @ 2 A	+5 V @ 0.1 A +3.3 V @ 0.3 A	UL/TUV/CB/CCC	100,000 hours @ 25 °C
PS-400ATX-ZB (ATX, PFC)	400 W	AC 100 ~ 240 V (Full-range)	+5 V @ 35 A, +3.3 V @ 25 A +12 V @ 30 A, -12 V @ 1 A -5 V @ 0.8 A, +5 Vsb @ 2 A	+5 V @ 3 A +12 V @ 1 A +3.3 V @ 1 A	UL/TUV/CB/CCC	91,000 hours @ 25 °C
PS-300ATX-DC48 (ATX)	300 W	DC -48 V	+3.3 V @ 28 A, +5 V @ 30 A, +12 V @ 15 A, -5 V @ 0.3 A, -12 V @ 0.8 A, +5 Vsb @ 2 A	+5 V @ 0.3 A, +3.3 V @ 0.3 A, +12 V @ 0.2 A	UL/TUV/CB/CCC	100,000 hours @ 25 °C

Optional Accessories

Part Number	Description
1701400652	HDD cable, ATA 66/100, 45 cm + 20 cm
1750000073	Low profile P4 CPU cooler up to 3.2 GHz (89 W)
1759214200	Low profile P4 CPU cooler up to 2.8 GHz (0.13 micron 70W)
9684000014	3.5" FDD with black bezel
SCD COMBO	Black 5.25" compact storage kit with slim 24X CD-ROM and a 3.5" drive bay for FDD or HDD
SDVD-COMBO	Black 5.25" compact storage kit with slim-type 8X DVD + 24X CD-RW and a 3.5" drive bay for HDD/FDD
SCD-FDD-COMBO	Black 5.25" storage kit with slim 24X CD-ROM and standard 3.5" black FDD
SDVD-FDD-COMBO	Black 5.25" storage kit with slim-type 8X DVD + 24X CD-RW and standard 3.5" FDD

Ordering Information

Part Number	Power Supply	Backplane	Regulation
IPC-602P3-00XB	Without power supply, with ATX switch	PCA-6106P3V-0B1	None
IPC-602P3-25ZB	PS-250ATX-Z	PCA-6106P3V-0B1	UL, cUL, CE
IPC-602P3-30ZB	PS-300ATX-ZB	PCA-6106P3V-0B1	UL, cUL, CE
IPC-602P4-00XB	Without power supply, with ATX switch	PCA-6105P4V-0B2	None
IPC-602P4-25ZB	PS-250ATX-Z	PCA-6105P4V-0B2	UL, cUL, CE
IPC-602P4-30ZB	PS-300ATX-ZB	PCA-6105P4V-0B2	UL, cUL, CE

- 1 Industrial Motherboards
- 2 Industrial Motherboard Chassis
- 3 PICMG Single Board Computers
- 4 Industrial Computer Chassis
- 5 Industrial Computer Peripherals
- 6 6U CompactPCI Enclosures
- 7 6U CompactPCI Boards
- 8 6U CompactPCI I/O
- 9 6U CompactPCI Accessories
- 10 3U CompactPCI Systems
- 11 Internet Security Platforms
- 12 Network Application Ready Platforms